



**PILOT OPERATED
PRESSURE RELIEF VALVE
PPR 06**

ENGINEERING

2

Ref. No. D 23100

Technical specification

Construction	Two stage poppet valve.
Mounting	Threaded Cartridge, Factory standard.
Mounting position	Optional
Flow direction	From port 'P' to 'T'
Operating pressure	For port 'P' , 315 bar For port 'T' 60 bar
Hydraulic medium	Mineral oil
Viscosity range	10 Cst to 380 Cst.
Fluid temperature range	-20 ° to +70 °C. / +120 °C for Viton Seal (to be specified)
Fluid cleanliness requirement	As per ISO 16/13
Maximum flow handling capacity	30 lpm
Mass	200 gm

Performance curve

Oil used : ISO VG 68.

Pressure Drop Curve

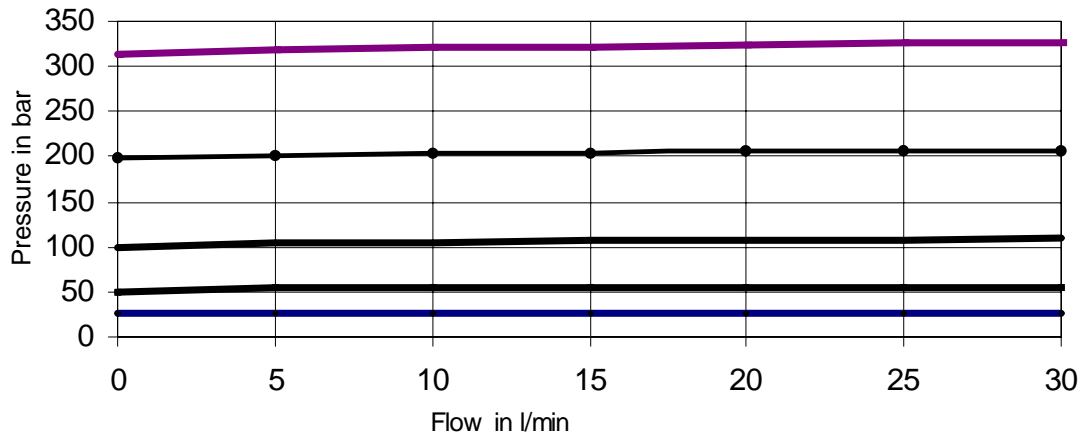

Ordering code

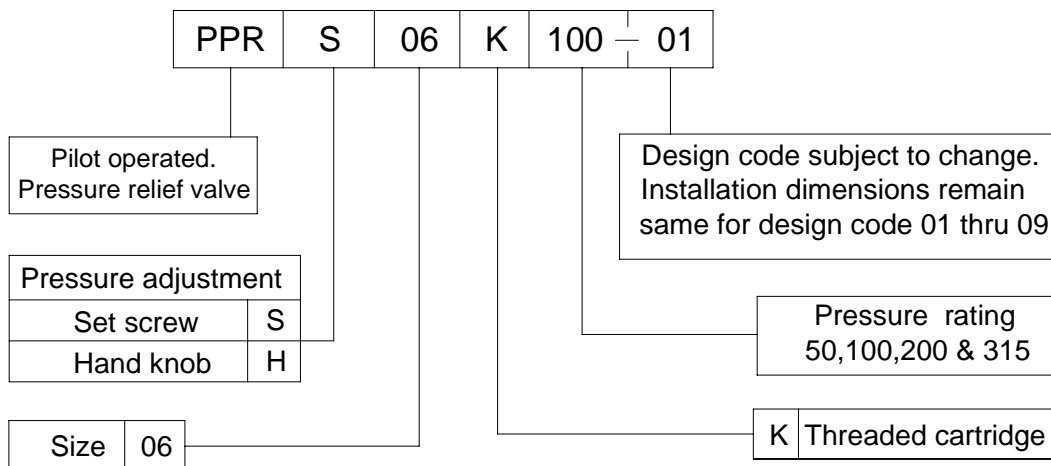

* Modular blocks to be ordered separately (Refer catalogue - Modular Relief Valves)



PILOT OPERATED PRESSURE RELIEF VALVE PPR 06

SERVICE

3

Ref. No. S 23100

Part Details & List

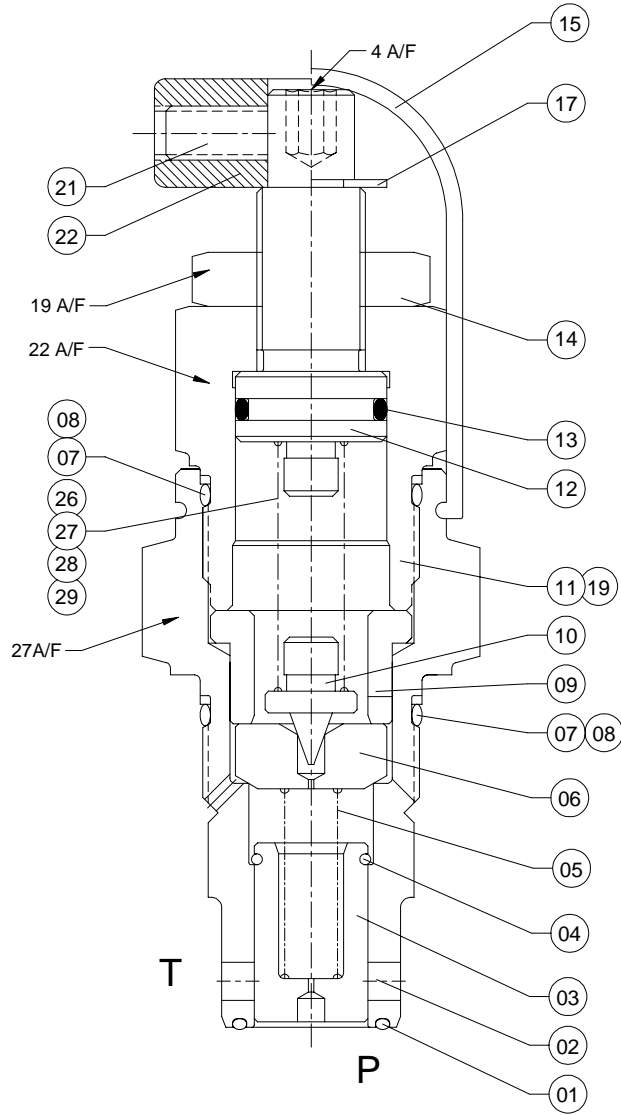

SI no	Description	Qty	Item no
* 01	O'Ring Ø12.5 id x 1 csd	01	23101
02	Main Bush	01	
03	Main Poppet	01	
04	Spring ring Ø8 id X 1 csd	01	
05	Spring	01	
06	Pilot valve seat	01	
* 07	O'Ring 17.5 ID x 1.5 CSD	02	23107
08	Back up ring 18 x 20.5 x 1 th	02	23108
09	Spacer	01	
10	Pilot Poppet	01	
11	Spring Casing	01	
12	Adjusting screw	01	
* 13	O'Ring Ø10.5 ID x 1.5 CSD	01	23113
14	Check Nut	01	
15	Rubber Cap	01	
17	Circlip `C' Type Ø6 Nominal	01	23117
19	Plug (Fixed Pr.)	01	
21	Hand knob	01	
22	Grub screw	02	
# 26	Spring 25 bar	01	23126
# 27	50 bar	01	23127
# 28	100 bar	01	23128
# 29	200 bar	01	23129
# 30	315 bar	01	23130

Note : * Recommended seal kit. * & # Recommended spare kit.

While ordering the individual spares / spare kit / seal kit, give part no. and complete details of model code as on the label.

Part Code : PPR06*-44(Part No)



PILOT OPERATED
PRESSURE RELIEF VALVE
PPR 06

SERVICE

4

Ref. No. S 23100